

Spell Community  
 Township 9 North  
 Range 15 West  
 Covington County, Ms.

N  
 S

\* SS-USA to William Speed 5-2-1859  
 and deeded to WF + KC Spell  
 1-29-1857  
 \*\* KC- Keziah Catherine Speed Spell  
 \*\*\* SS- not known when William Speed  
 got this - deeded to WF + KC Spell  
 1-29-1857

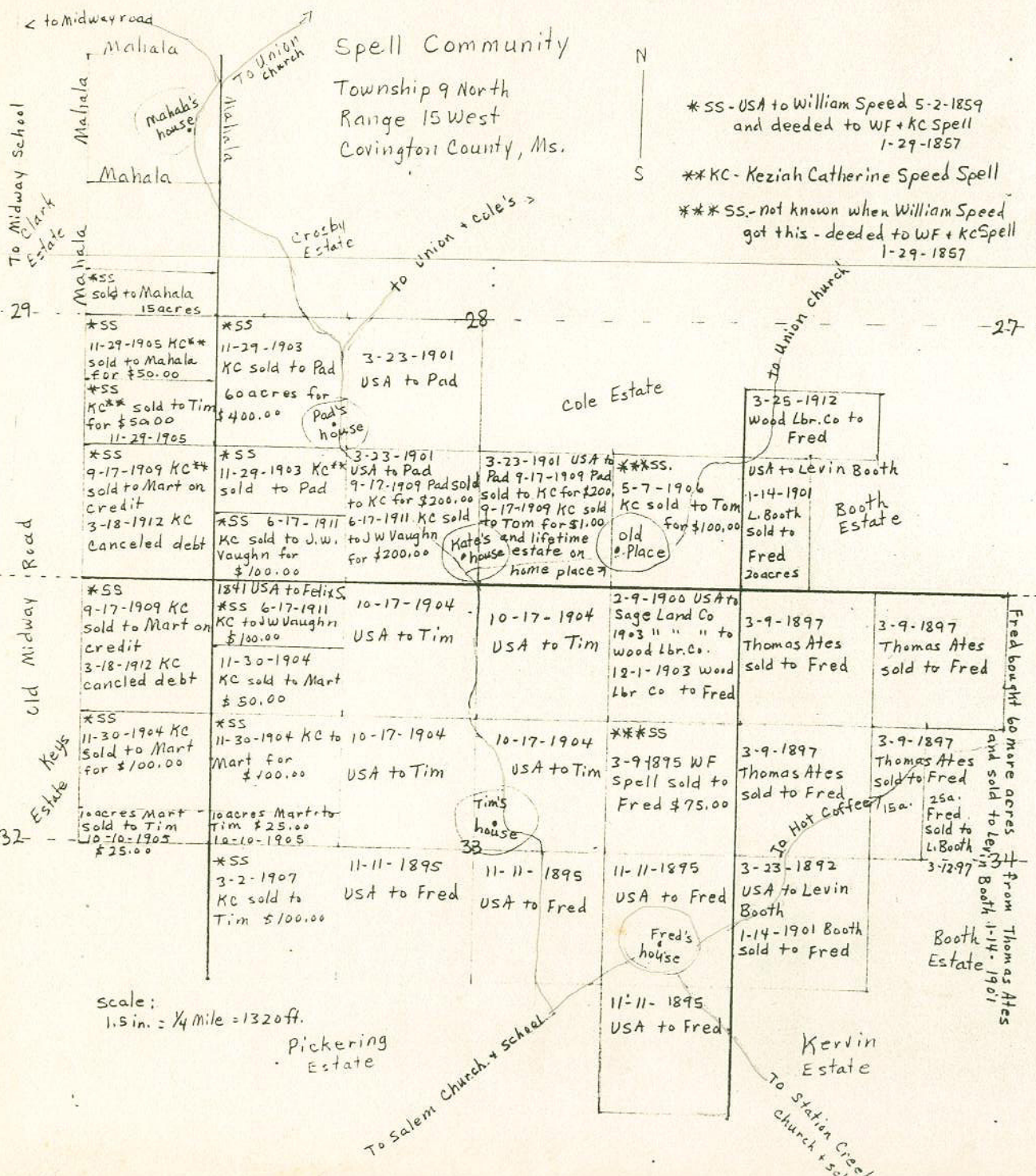

scale:  
 1.5 in. = 1/4 mile = 1320 ft.

Pickering  
 Estate

Kervin  
 Estate

Fred bought 60 more acres  
 and sold to Levin Booth  
 1-14-1901 from Thomas Ates